



Coolant Mixing Station

Typical applications

- Metal Working Fluids
 - Machining Fluids
 - Stamping Fluids
 - Rust Preventatives
- Cleaners
 - Part Washing Fluids
 - Floor Soap
 - Maintenance Cleaners

Equipment Specifications

- Positive Displacement Mix Pump
 - 2 to 7 GPM Mix Flow Rate
 - 2.4% to 12.3% Adjustable Mix Ratio
- Water @ 20 psi+
- Electrical Control w/ "On" & "Off" Push Buttons
- Power Requirement: 120V-5 Amps
- 20ft. Electrical Cord
- Low Chemical Alarm
- 5 Micron Water Filter

Optional Features

- Viton/Buna-N Seals
- Remote Level Sensors w/ 30ft. Cord
 - Overflow Sensor w/ Alarm
 - Add Fluid Sensor
 - Overflow Alarm
- Cycle Timer
- Drum Hardware/Tote Hardware

The Coolant Mixing Station uses a positive displacement pump to mix water soluble fluids efficiently and at accurate concentrations. Designed specifically for mixing water based metal working fluids, the HBMS-7-12-120V automatically mixes at 2 to 7 GPM. The concentration can be changed by the user to ensure optimal fluid performance on a Just-In-Time basis. The system runs on 120 volt. Industrial Fluid Systems will custom build a system to meet your requirements.



INDUSTRIAL FLUID SYSTEMS

22200 Ryan Road
Warren, MI 48091

Phone: 800-343-8106

Fax: 586-754-8284

www.industrialfluidsystems.com

Model: HBMS-7-12-120V-CLO



INDUSTRIAL FLUID SYSTEMS

Coolant Mixing Station

EXAMPLE:

HBMS - 7 - 12 - 120V - CLO - P

HYDRO-BLEND MIXING SYSTEM

MIXING PUMP FLOW RATE

Hydro-Blend Mixing Pump = 7 GPM

MIXING RATIO

6120-A-V: 8% = 8

6180-A-V: 12% = 12

6470-A-V: 26% = 26

POWER SOURCE

120V = 120

REMOTE LEVEL SENSOR

Coolant Chemical = C

Coolant Low = L

Coolant Overflow = O

CHEMICAL SUPPLY

P = Pail

D = Drum

T = Tote

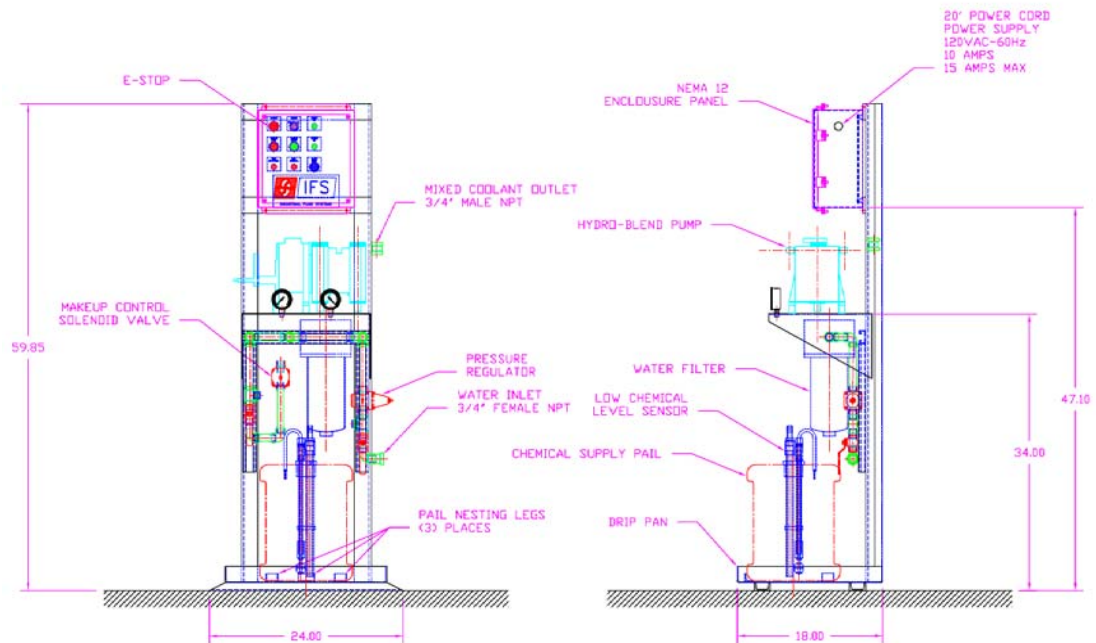

INDUSTRIAL FLUID SYSTEMS

22200 Ryan Road

Warren, MI 48091

Phone: 800-343-8106

Fax: 586-754-8284

www.industrialfluidsystems.com

Model: HBMS-7-12-120V-CLO